

### Product

DGFI

### Application

Ceiling mounted  
Installation height: 2.6-4 m

### Construction

Constructed in painted steel sheet RAL 9010 gloss 80 (RAL 9003 on request)

### SPECIFICATION

Panel diffuser with fixed stamped deflectors.  
Swirl flow geometry with high induction effect.  
Diffuser suitable for heating and cooling, even with temperature differences high between supply air and room air

### VERSIONS

DGFIP Panel 595x595

### ACCESSORIES

PQOS/PQOI Steel plenum galvanized with side connection.  
PQVS/PQVI Steel plenum galvanized with top connection.  
PQOP Polystyrene plenum. available for 595x595 panel

## DIMENSIONS

DGFI Model	L mm	Ø mm
300	298	236
400	398	336
500	498	436
600	595	536
P300	595	236
P400	595	336
P500	595	436

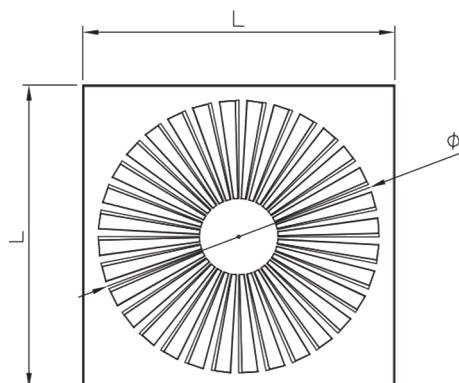

## PLENUM

Model	A mm	B mm	D mm	K mm	H mm
PQV/O_300	295	260	156	200	350
PQV/O_400	390	360	196	200	350
PQV/O_500	490	460	196	200	350
PQV/O_600	590	560	246	200	350

Galvanised/insulated sheet metal plenum

**LEGEND**

- 1 Damper control
- 2 Grid equalizer

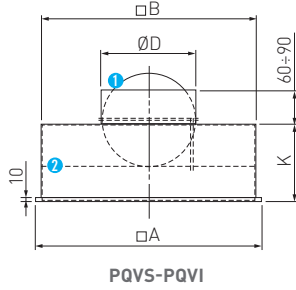

**LEGEND**

- 1 Damper control
- 2 Grid equalizer

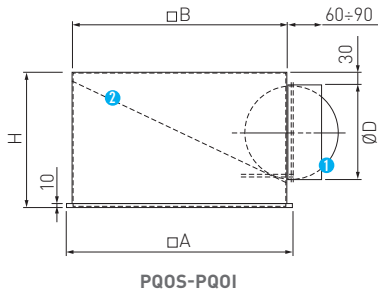

Polystyrene plenum

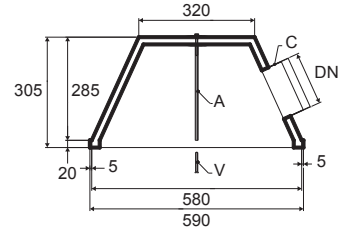

\* connection hole selectable from 4 sizes pre-cut as shown in Fig. 1

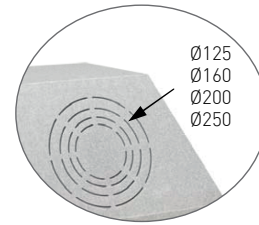

FIG. 1

### SELECTION TABLE

DGFI Model	Ak m <sup>2</sup>	Q [m <sup>3</sup> /h]		L <sub>w</sub> [dB(A)]		X <sub>(0,25)</sub> [m]		D <sub>pt</sub> [Pa]	
		min	max	min	max	min	max	min	max
300	0,010	125	250	25	45	1,5	3	5	22
400	0,016	175	380	25	45	1,8	4	7	32
500	0,033	275	600	25	45	1,8	4,5	8	37
600	0,049	400	800	25	45	1,8	4	7	30