

# RPMCK

## Rectangular constant flow rate regulator



### Product

RPMCK

### Construction

Body and finish in galvanized steel  
Thickness acc. EN 1751 Tightness Class C

### Actuation

Manual mechanical operation

### SPECIFICATION

Constant flow rate regulator.  
Nominal size 200x100 ÷ 600x600.  
Length L = 350 mm.  
Air flow volume  
250 ÷ 12000 m<sup>3</sup>/h.  
Precision 10% -15% (at min./max.  
positions 20%).

### APPLICATIONS

Maintains constant flow rate within a  
differential pressure range

### WORKING CONDITIONS

Correct regulator operation is ensured  
under the following conditions:

- maximum air flow velocity 12 m/s
- maximum duct pressure 1000 Pa
- operating limits 0° / 50°C

ON REQUEST: Version with 50 mm  
acoustic insulation

## DIMENSIONAL

AxB	X	Air flow rate		AxB	X	Air flow rate	
		min. m <sup>3</sup> /h	max. m <sup>3</sup> /h			min. m <sup>3</sup> /h	max. m <sup>3</sup> /h
mm	mm			mm	mm		
200 x 100	62	250	700	500 x 200	81	1100	3400
200 x 150	62	400	1000	500 x 250	87	1500	4200
200 x 200	62	500	1300	500 x 300	120	1800	4800
300 x 100	62	400	1000	500 x 400	*81	2200	6800
300 x 150	62	500	1500	500 x 500	*87	3000	8400
300 x 200	62	600	2000	600 x 200	120	1500	4000
300 x 250	62	800	2500	600 x 250	120	1800	5000
300 x 300	81	1000	3000	600 x 300	120	2100	6000
400 x 200	81	900	2700	600 x 400	*120	3000	8000
400 x 250	87	1200	3400	600 x 500	*120	3600	10000
400 x 300	81	1500	4200	600 x 600	*120	4200	12000
400 x 400	*81	1800	5400				

\* For B ≥ 400 the regulator consists of two units assembled in the same casing



Diffusion

Components  
for perfect air  
distribution in HVAC  
systems

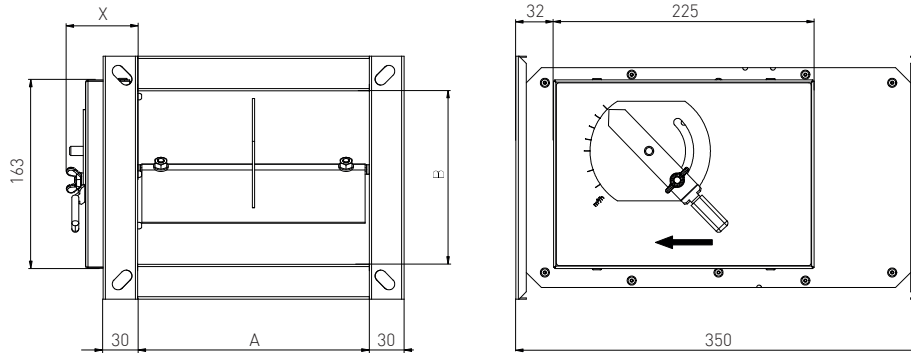

RPMCK

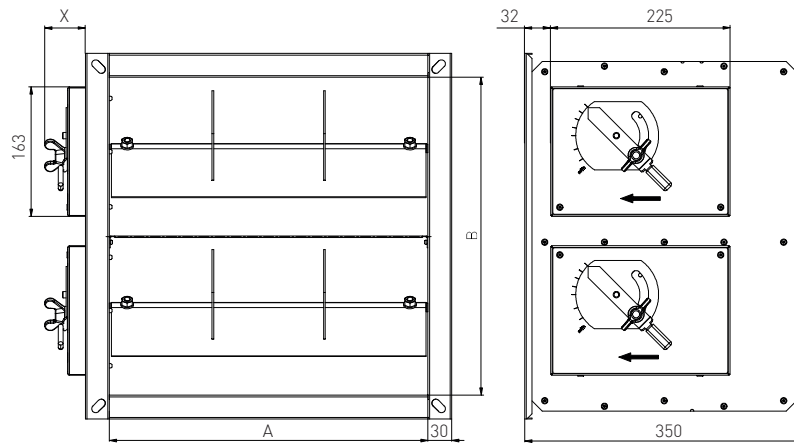

RPMCK B  $\geq$  400