

MPC EC

EC plug fan box unit



Product

MPC EC

Application

Civil and industrial applications

Construction

External housing: galvanized steel sheet lined with 30 mm non-combustible mineral wool

CABINET

Double-wall cubic casing in galvanized steel sheet lined with 30 mm fire-resistant mineral wool, non-combustible according to DIN EN 13501-1, building material class A1. Cabinet equipped with condensate collection tray and drain valve.

For cleaning and maintenance work, the inspection door can be completely removed using the door handle.

The door handle is included in the supply and can be mounted on any side, as desired.

The side panels and the cap can be easily removed, allowing three possible discharge directions (left, right or upward).

The side panels are installed in the frame so that no screws protrude inside the enclosure.

FAN

The high-performance impeller with backward curved blades consists of a powder-coated steel plate.

The impeller is dynamically balanced according to quality class G 6.3 of DIN / ISO 1940, on 2 planes.

Ball bearings are maintenance-free and self-lubricated, sealed on both sides.

In three-phase models, the impeller is mounted on the motor shaft with a special shaft seal that prevents the ingress of oil and water.

MOTOR

BRUSHLESS permanent magnet motor, directly coupled. Speed regulation via 0-10V signal or optional manual potentiometer, progressive start-up, overheating protection for electronics/motor, low voltage/phase loss detection. Power supply 400V - 3ph - 50/60Hz. Operating temperature range: -25 ÷ +40 °C. High extraction performance, compact dimensions, easily adjustable operating point, maximum reliability, virtually maintenance-free.

APPLICATIONS



TECHNICAL
ROOMS



LARGE SPACES



HOSPITALS



CANTEENS



RESTAURANTS



FAST FOOD



OFFICES



DIMENSIONS

MPC EC Model	A mm	B mm	C mm	ØD mm
225 EC 40	386	417	500	195
250 EC 40	386	417	500	220
280 EC 40	386	417	500	240
400 EC 40	586	617	700	340
450 EC 40	586	617	700	350
500 EC 40	586	617	700	430
560 EC 40	786	817	900	500
630 EC 40	786	817	900	550

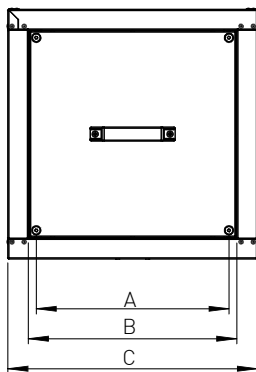
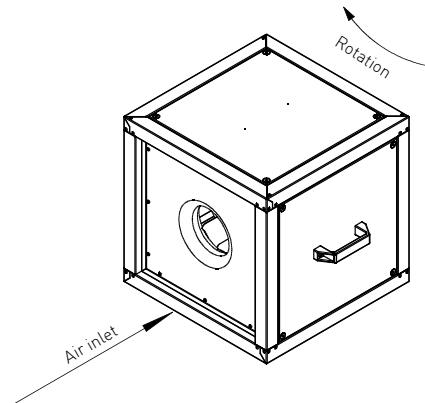

LEFT SIDE VIEW

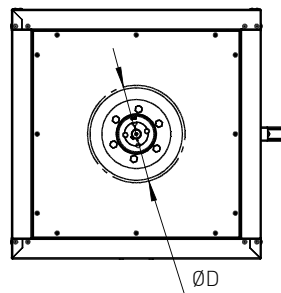

FRONT VIEW

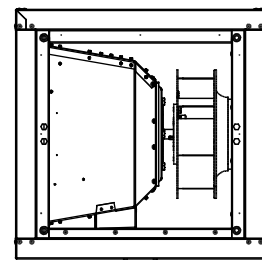

RIGHT SIDE VIEW

TECHNICAL CHARACTERISTICS

MPC EC Model	Flow rate max. m ³ /h	Speed max. RPM	Power supply Volt/Hz	I max. A	Power max. absorbed W	Sound power dB(A)	Degree of protection	Wt. kg
225 EC 40	1030	2920	230/50	0,99	116	69	IP44	27,7
250 EC 40	1520	2995	230/50	1,76	207	79	IP44	28,9
280 EC 40	2030	2900	230/50	1,91	270	78	IP44	29,1
400 EC 40	5680	1935	230/50	2,44	529	76	IP44	62,0
450 EC 40	6270	1510	230/50	2,43	527	75	IP44	65,0
500 EC 40	9830	1600	400/50	2,10	1343	81	IP44	56,2
560 EC 40	15560	1790	400/50	5,42	3530	89	IP44	101
630 EC 40	17720	1300	400/50	4,25	2733	84	IP44	98,0