

AFTS

Ducted axial fan with compact motor



Product AFTS
Installation Ducted

FEATURES

AFTS fans are ideal for applications requiring substantial air flow rates and low pressures, in duct mounting applications.

They are characterized by extreme compactness, thanks to the minimal size of the motor-impeller assembly; therefore, with dimensions smaller than those of a standard short-casing axial fan with a standard motor, the absence of protruding parts from the flanges, typical of "long-casing" fans, has been achieved, with the consequent possibility of installation both at the ends and in the middle of ductwork. Another distinctive feature is the perfect speed regulation capability, without producing noise (electrical hum) or abnormal current absorption.

FAN

Steel sheet casing protected with epoxy-polyester paint coating. Flanges dimensioned according to UNI EN ISO 13351/Tab.1. High-efficiency impeller with airfoil profile blades, with adjustable pitch angle at standstill, in technopolymer or cast aluminum, die-cast aluminum hub. Balancing according to UNI ISO 21940-11 standards.

MOTOR

AC asynchronous electric motor, three-phase or single-phase with thermal protection, variable speed, IP 55 protection, insulation class F, duty S1. Execution 5 (direct coupling with overhung impeller).

ON REQUEST

Versions with impeller having die-cast aluminium blades.
Versions with airflow from impeller to motor, position B (FGM).
Flat safety guard (FPG-DU) (Required for free inlet use).
Fixing feet (FF-DU).
Suction nozzle (IN).
Anti-vibration joint (FC-DU).
Anti-vibration supports (AM).
Counter flange (CF-DU).
Circular silencers (SIL-DU).

APPLICATIONS

Ventilation of plants, parking garages, machine rooms, livestock farms, cooling of electrical and refrigeration equipment, in the industrial or naval sector.

APPLICATIONS



PLANT VENTILATION



CAR PARKS

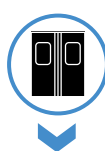

MACHINE ROOM



LIVESTOCK FARMS



COOLING OF ELECTRICAL EQUIPMENT, COLD ROOMS, ETC.

TECHNICAL CHARACTERISTICS

Ducted air	Clean or slightly dusty, non-abrasive
Conveyed air temperature	-20°C / +50°C
Supply voltage	Three-phase version (T) 400V-3Ph-50Hz Single-phase version (M) 230V-1Ph-50Hz
External terminal block	Airflow from motor to impeller, position A (FMG)



DIMENSIONS

Model	ØA mm	B mm	ØC mm	ØD mm	E mm	ØF mm	Weight(*) kg
31	310	260	355	390	8	10	10
35	360	260	395	430	8	10	11
40	410	260	450	490	8	12	15
45	460	260	500	540	8	12	16
50	510	260	560	600	12	12	17
56	570	260	620	655	12	12	22
63	640	260	690	725	12	12	23
71	710	260	770	805	16	12	26

(*) Indicative

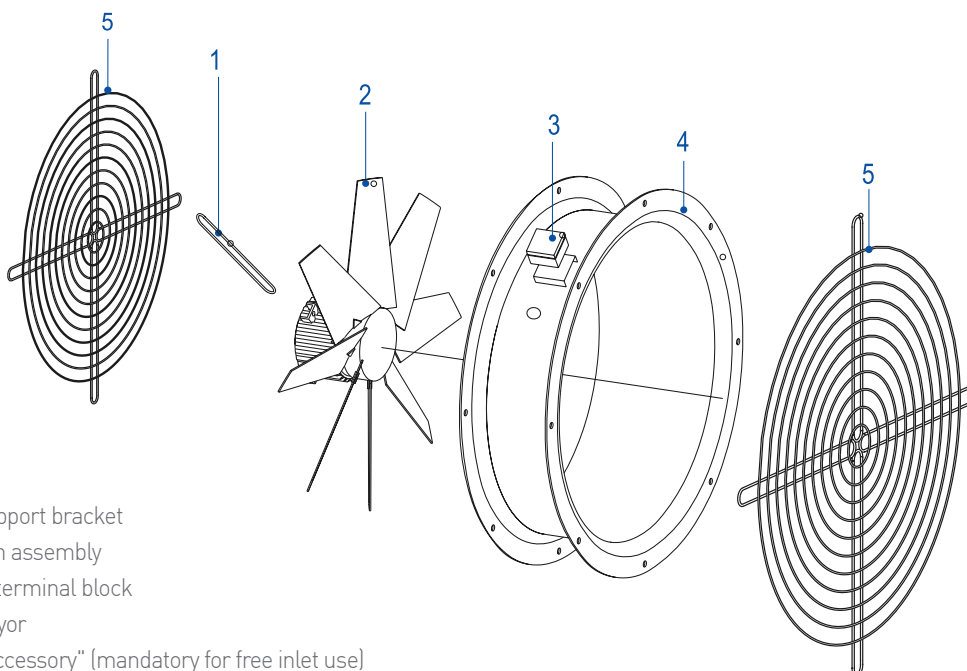
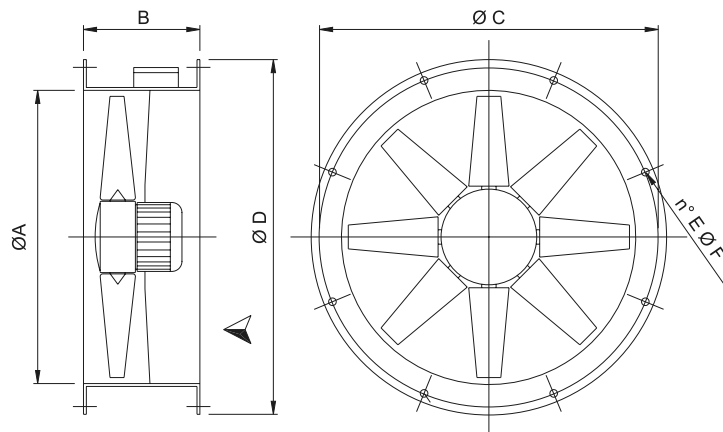

- 1- Motor support bracket
- 2- Motor-fan assembly
- 3- External terminal block
- 4- Air conveyor
- 5- Guard "accessory" (mandatory for free inlet use)

AFTS

Ducted axial fan with compact motor

CHARACTERISTIC CURVES

4 POLES (1400 RPM) - SINGLE-PHASE (1PH-230V 50HZ)

Model	Flow rate (m³/h)	Pm kW	In max A	Lp dB(A)
314 M	2300	0,09	0,8	50
354 M	3500	0,09	0,8	54
404 M	6000	0,18	1,7	55
454 M	7000	0,25	2,2	58
504 M	8500	0,25	2,3	62
564 M	11500	0,55	3,8	69

4 POLES (1400 RPM) - THREE-PHASE (3PH-400V 50HZ)

Model	Flow rate (m³/h)	Pm kW	In max A	Lp dB(A)
314 T	2300	0,09	0,5	50
354 T	3500	0,09	0,5	54
404 T	6000	0,18	0,75	55
454 T	7000	0,25	1,1	58
504 T	9000	0,35	1,5	62
564 T	11500	0,55	1,6	69
634 T	13500	0,75	2,2	72
714 T	17000	1,1	2,6	73

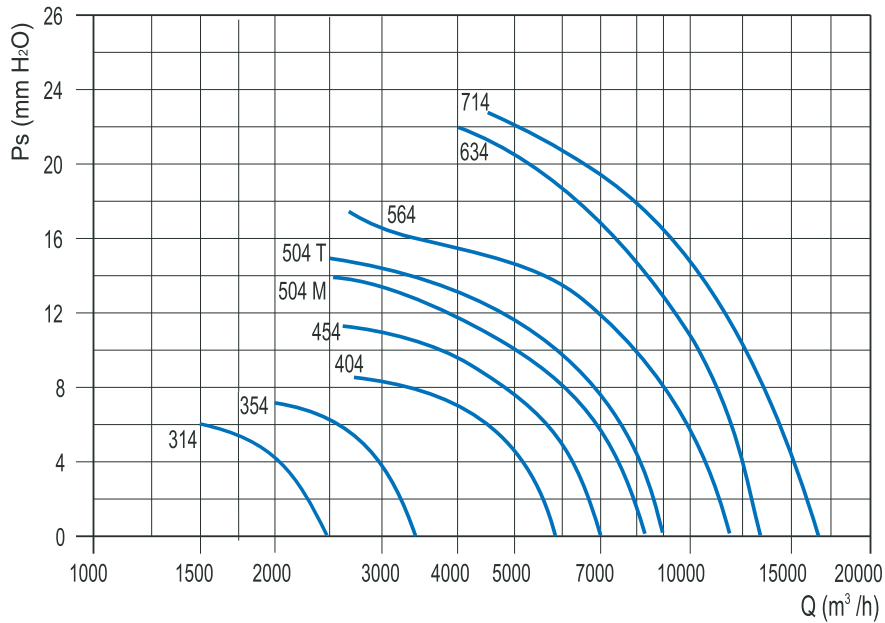



6 POLES (900 RPM) - THREE-PHASE (3PH-400V 50HZ)

Model	Flow rate (m ³ /h)	Pm kW	In max A	Lp dB(A)
506 T*	6000	0.18	0.8	53
566 T	9500	0.25	1.2	60
636 T	13000	0.55	1.7	62
716 T	14500	0.55	1.7	64

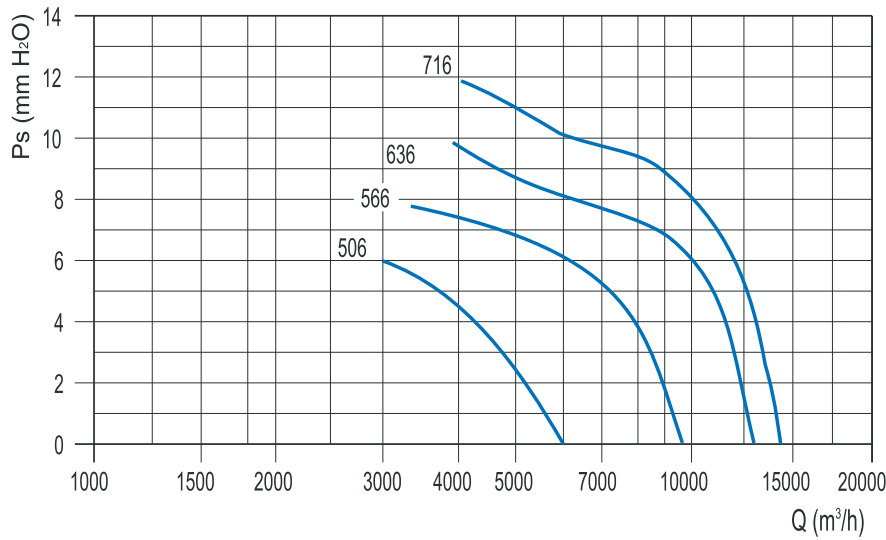

8 POLES (700 RPM) - THREE-PHASE (3PH-400V 50HZ)

Model	Flow rate (m ³ /h)	Pm kW	In max A	Lp dB(A)
718 T*	10500	0.28	1.3	58

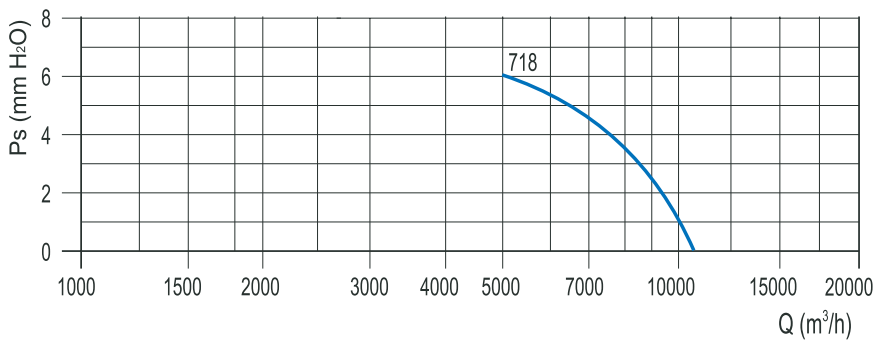

(*) Only for installation outside EU.