

REC R 800

Centralized heat recovery unit with controls 800 m³/h



Vertical



Horizontal

DESCRIPTION

Centralized heat recovery unit with plug-and-play wireless controls and integrated bypass. Self-supporting structure in pre-painted sheet metal, thermal/acoustic insulation in 22 mm rock wool.

HEAT RECOVERY UNIT

Counter-flow heat recovery unit, in polypropylene, with efficiency >90%.

FANS

EC fans, backward-curved centrifugal, low consumption.

Product

REC R 800 H/V

Installation

Horizontal/Vertical

Efficiency

ratings

> 90%

FILTERS

F7 (ePM1 70%) filters with low pressure drop, for both extract and fresh air

TECHNICAL SPECIFICATIONS

Parameter description	Unit of measurement	Values
Air flow rate	mc/h	900
Available static pressure	Pa	55 (V) / 85 (H)
Thermal efficiency	%	>90
Nominal voltage	V	230 – 1F
Frequency	Hz	50-60
Consumption at maximum flow rate	A	2.9
Nominal power	W	380
Filters	Class	F7 (ePM1 70%) SUPPLY M5(ePM10 50%) EXTRACT



MVHR

Maximum air quality
in residential environment

DIMENSIONS

Horizontal version (H)

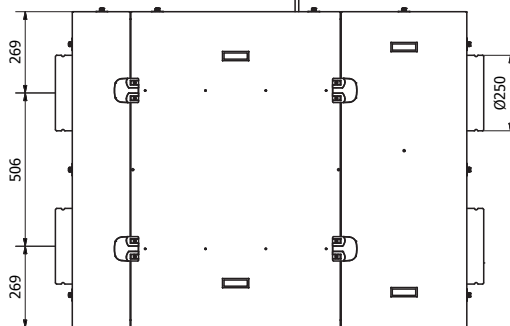
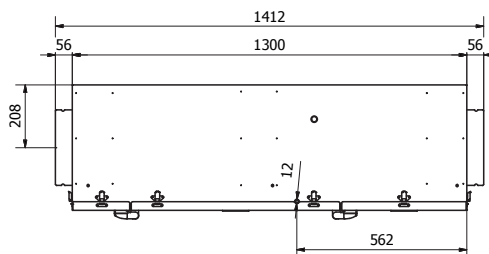
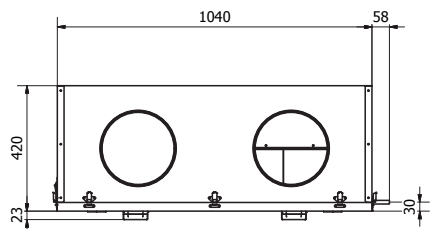
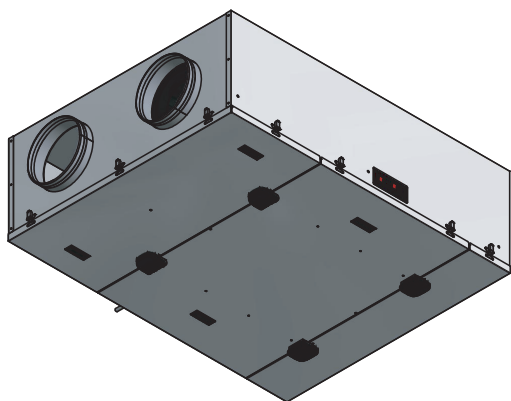

CONFIGURATIONS

Nominal duct diameter: Ø 250 mm Weight: 100 kg
Sound pressure level at 1.5 m (Lpa in dB(A)): 47 dB(A)

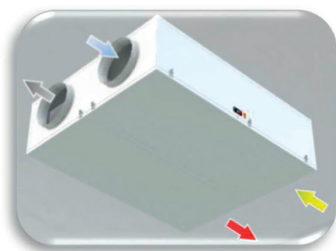

HS (standard)
CEILING

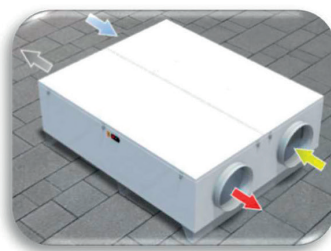

HB*
BASE

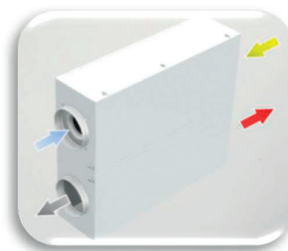

HP*
WALL

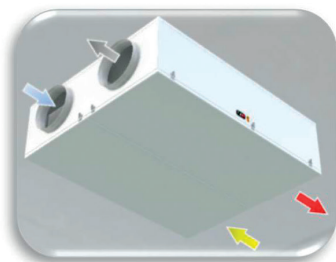

KS*
CEILING

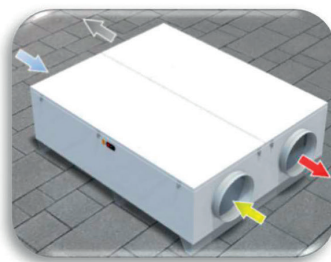

KB*
BASE

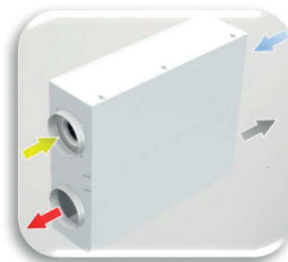

KP*
WALL

LIGHT BLUE	RENEWAL (outdoor air intake)	YELLOW	RETURN (extraction from the room)
GREY	EXHAUST (exhaust to outside)	RED	SUPPLY (room supply)

DIMENSIONS

Vertical version (V)

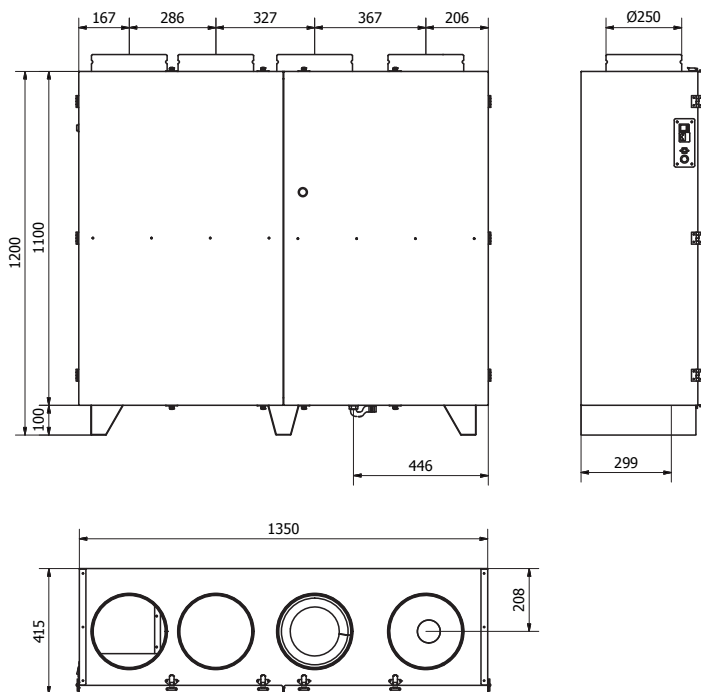
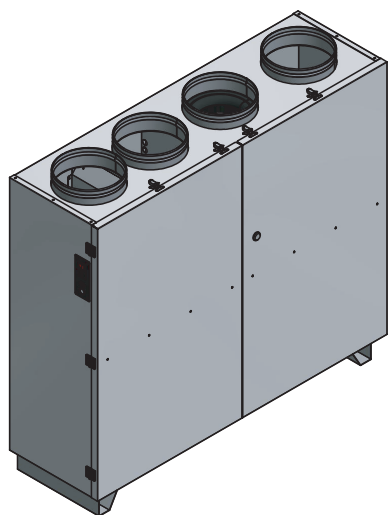

CONFIGURATIONS

Nominal duct diameter: $\varnothing 250$ mm Weight: 95 kg
 Sound pressure level at 1.5m (L_{pa} in dB(A)): 47 dB(A)

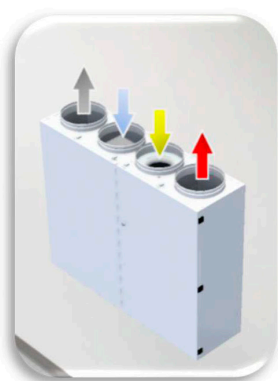

UA (standard)
WALL



UB*
WALL

LIGHT BLUE	RENEWAL (outdoor air intake)	YELLOW	RETURN (extraction from the room)
GREY	EXHAUST (exhaust to outside)	RED	SUPPLY (room supply)



MVHR

Maximum air quality
in residential environment

AERAILIC PERFORMANCE

	Air flow rate nominal (m ³ /h)	Air flow rate nominal q _{nom} (m ³ /s)	Efficiency fan η _{s,Fan} (%)	Efficiency heat exchanger η _{L_nvu} (%)	Sound power L _{wa} (dB(A))	Internal specific power SFP _{int} (W(m ² /s))	Nominal external pressure Δp _{s,ext} (Pa)
1	900	0,250	52,8	80,1	57	1154,5	85
1_b	950	0,264	51,1	79,3	58	1257,6	37
2	298	0,083	32,3	92,1	65	1003,3	537
3	59	0,016	13,3	98,3	49	203,4	96
4	347	0,096	37,1	90,9	42	367	5
5	900	0,250	50,7	80,1	57	1142,6	0
5_b	950	0,264	50,6	79,3	58	1244,6	0
6	449	0,125	46,3-	88,7	56	524	170

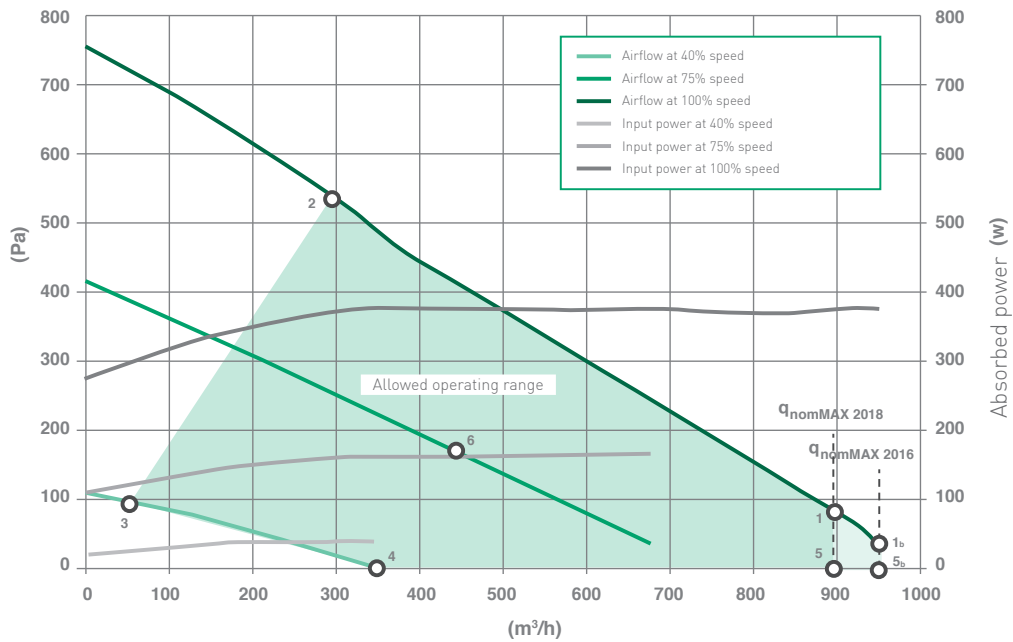

HEAT RECOVERY UNIT THERMAL EFFICIENCY

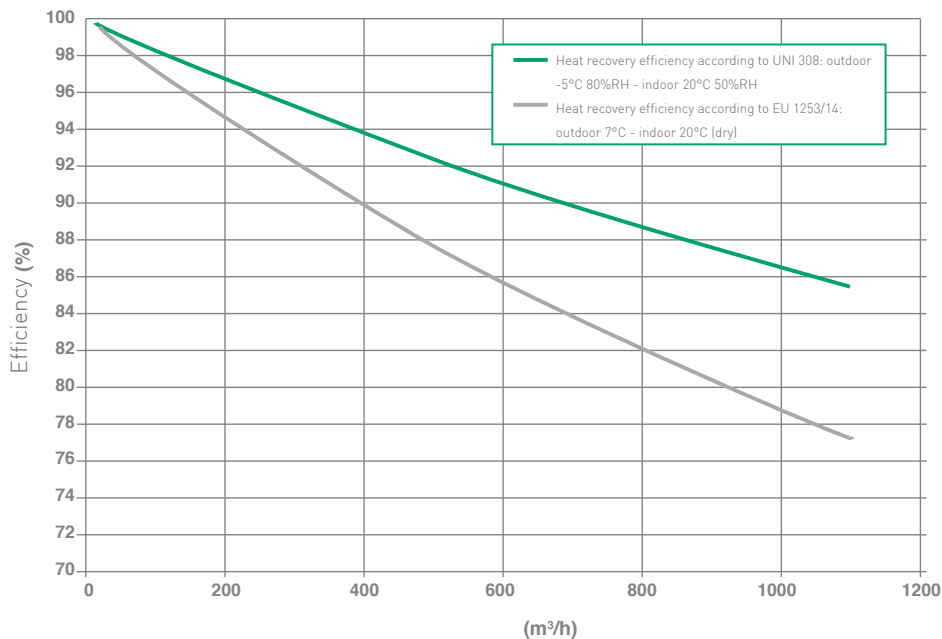

CONTROL TYPES

Electronic control board with numerous functions, including:

- speed selection 1, 2, 3 or automatic
- constant flow/pressure management option (optional)
- automatic bypass management for free-cooling and free-heating
- frost protection (also with electric heater),
- filter alarm with hour counter (optional with pressure switch)
- management of humidity, temperature, air quality, CO sensors₂...
- control of water coils and electric heaters for pre-treatment and/or post-treatment.
- ModBus communication.

Available in the following versions:

- SE on-board electronic card;
- EB white LCD display, with integrated humidity and room temperature sensors
SE+EB are included in the heat recovery unit supply
- ET colour touch-screen display (on request)

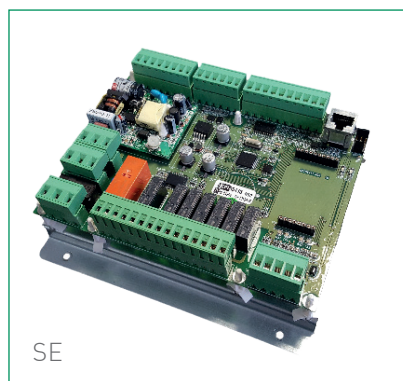

SE



EB



ET

**MVHR**Maximum air quality
in residential environment**PRODUCT DATA SHEET**

Model identifier		REC R 800 H EB	REC R 800 V EB
Product type		BNVU, bidirectional	BNVU, bidirectional
Motor type		Variable speed	Variable speed
Heat recovery system		Counter-flow heat exchanger	Counter-flow heat exchanger
Heat recovery thermal efficiency*		80,1%	80,1%
Nominal air flow rate (m ³ /s)		0,25 m ³ /s	0,25 m ³ /s
Actual electrical power consumption (kW)		0,377 kW	0,377 kW
Internal specific fan power SFPint (W/(m ³ /s))*		1155 W/(m ³ /s)	1262 W/(m ³ /s)
Face velocity at nominal flow rate (m/s)*		1,67 m/s	1,67 m/s
Nominal external pressure Δs.ext (Pa)		85 Pa	55 Pa
Internal pressure drop of ventilation components Δs.int (Pa)*		294 Pa	324 Pa
Fan static efficiency η _{s,Fan} **		52,80%	52,80%
Leakage rate (%)	indoor	3,7%	3,7%
	outdoor	4,8%	4,8%
	recirculation	Not applicable	Not applicable
Filter classification		fresh air F7 (ePM1 70%) extract M5 (ePM10 50%)	fresh air F7 (ePM1 70%) extract M5 (ePM10 50%)
Position and description of visual signal filter warning		Displayed alarm on the remote display	Displayed alarm on the remote display
Sound power level (L _{wa} in dB(A))		59 dB (A)	58 dB (A)

* as per regulation no. 1253/2014

** calculated as per regulation no. 1254/2014

* 3 humidity, CO sensor, air quality, presence sensor...